



# De Nederlandsche Bank

## Compliance Function in Central Banks

Joanne Kellermann (Director)

De Nederlandsche Bank

## OBJECTIVES COMPLIANCE FUNCTION

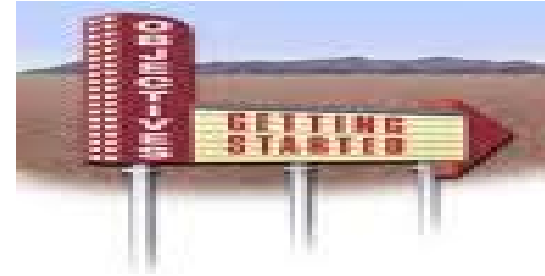

1. Developing and maintaining DNB's compliance and integrity policy
2. Raising integrity awareness amongst DNB staff
3. Identifying compliance and integrity risks and advising on how to mitigate these risks
4. Operating DNB's rules of conduct and monitoring whether or not the rules of conduct are complied with by employees.

# DEVELOPING AND MAINTAINING DNB'S COMPLIANCE AND INTEGRITY POLICY

- C&I department not automatically a natural partner for other departments
- make sure compliance is consulted in significant developments and projects
- make sure this consultation is integral part of governance procedures.



# RAISING THE INTEGRITY AWARENESS AMONGST DNB STAFF





# AWARENESS



- Ensure good communication previous to workshops
- Exemplary role of management is essential

# Awareness of integrity issues needs maintenance



# INTEGRITY AS A CORPORATE VALUE

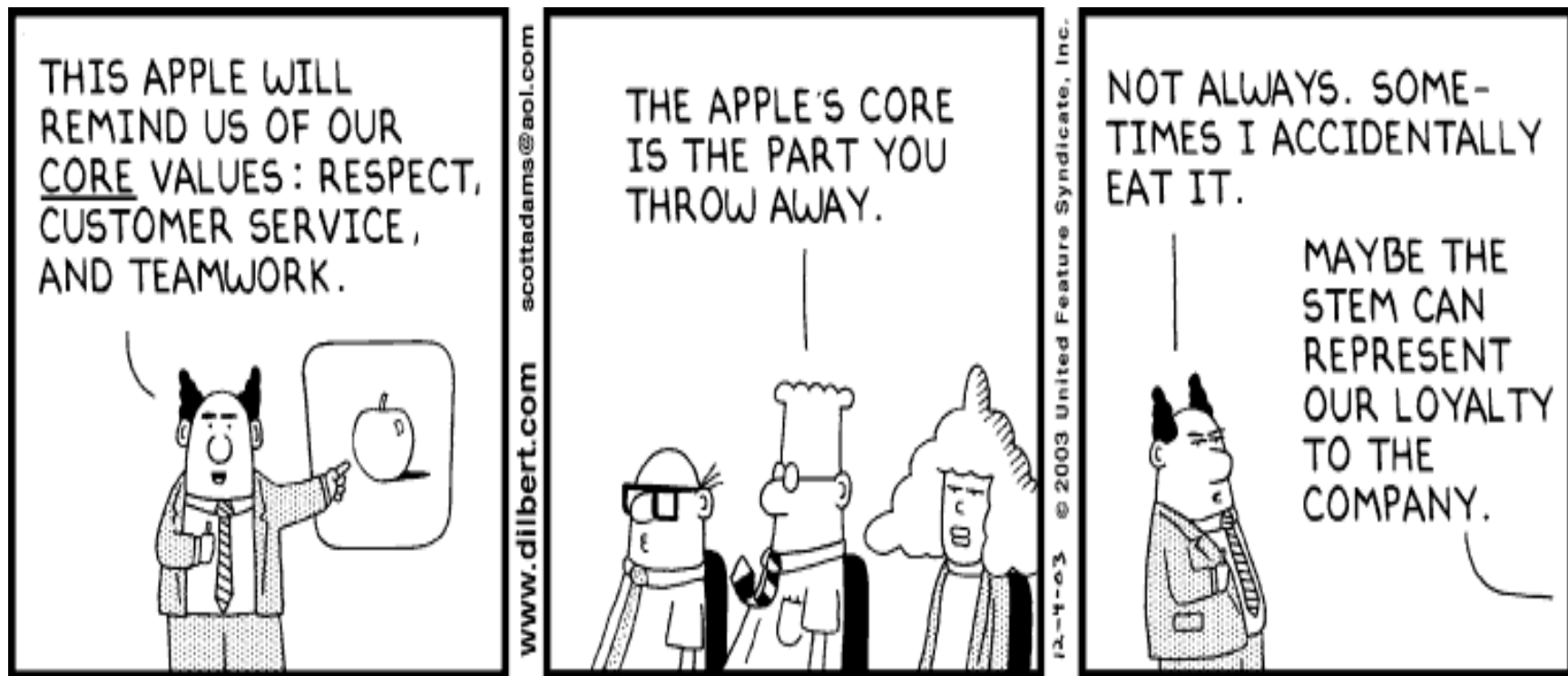

# WHAT KIND OF CORPORATE CULTURE IS NECESSARY?





# CULTURE-HOUSE

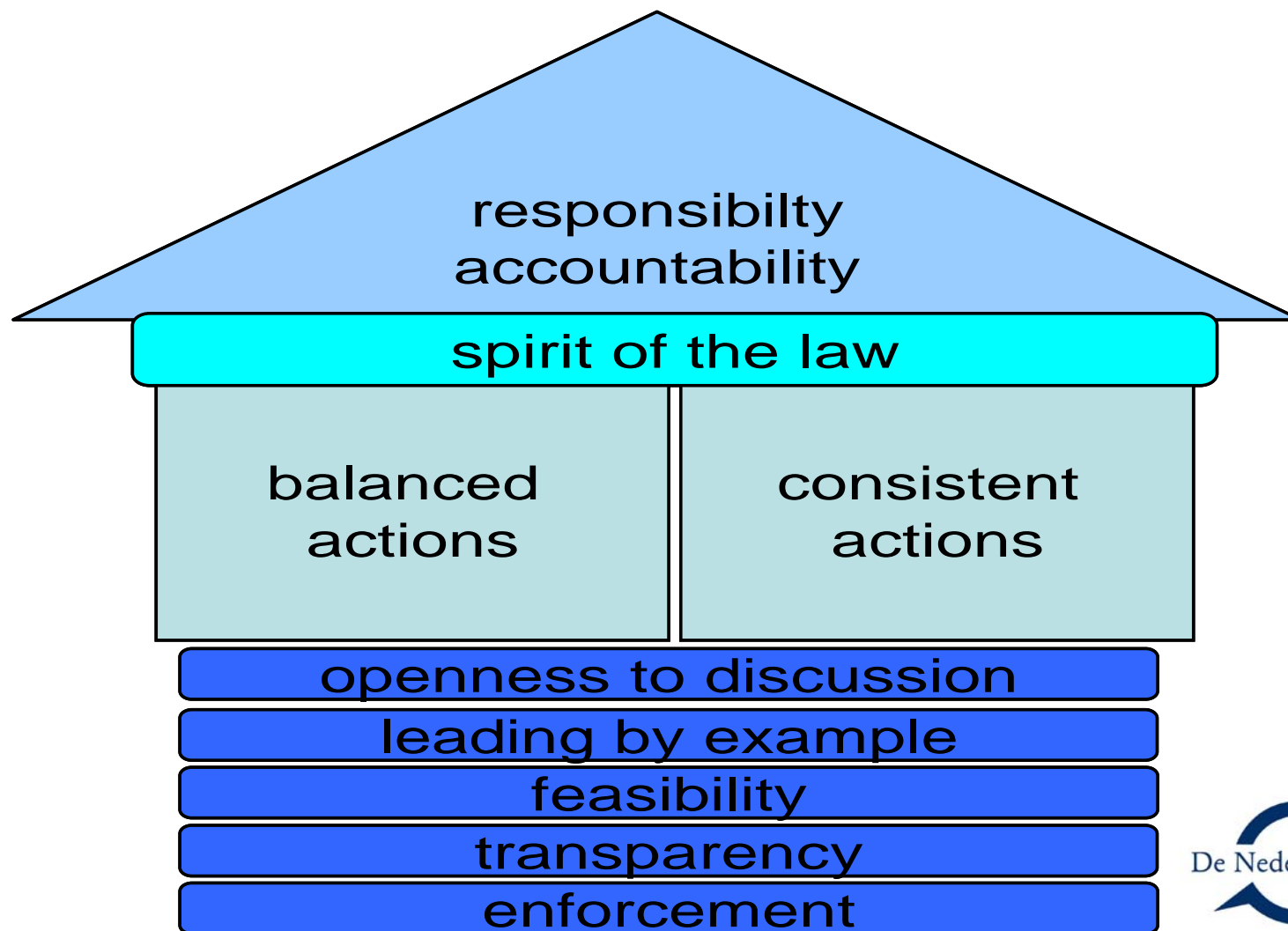

# THE ROOF = THE AIM

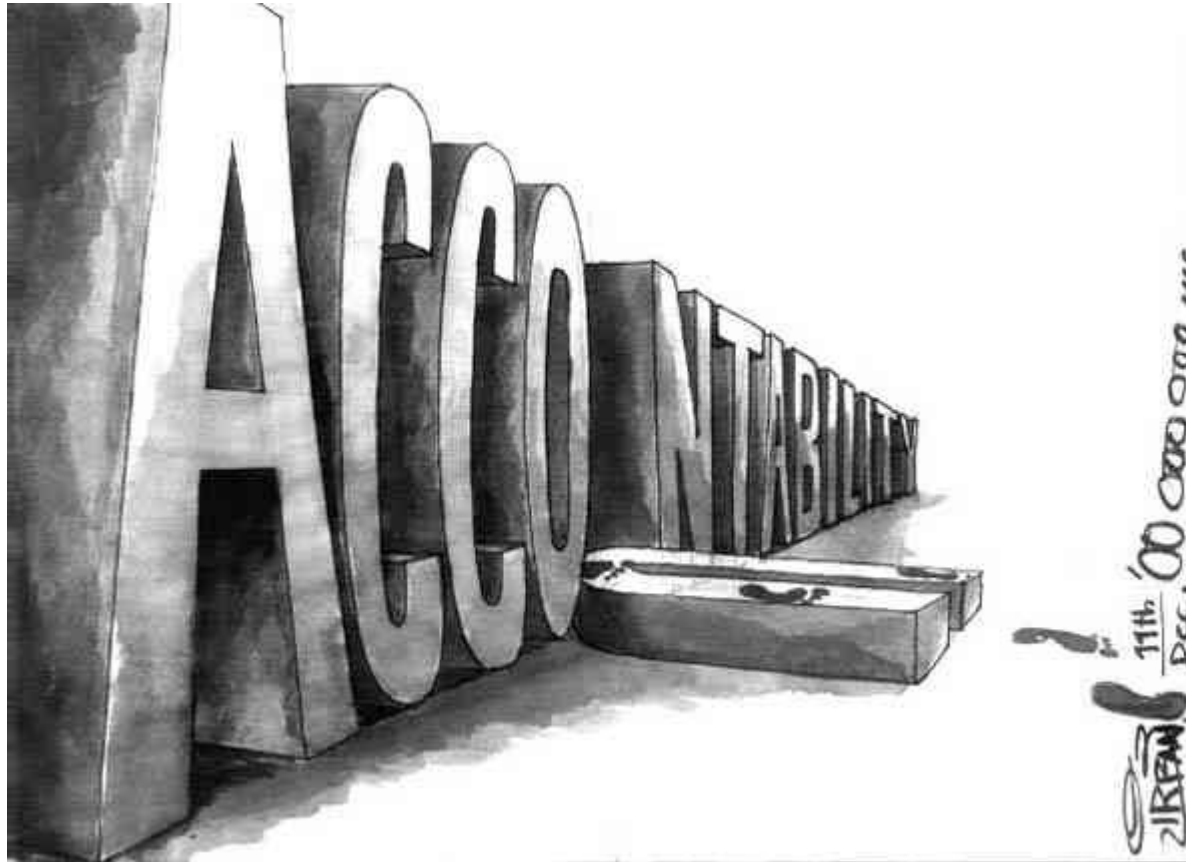

**Responsibility and accountability**

# THE SUPPORTING BEAM = THE SPIRIT OF THE LAW

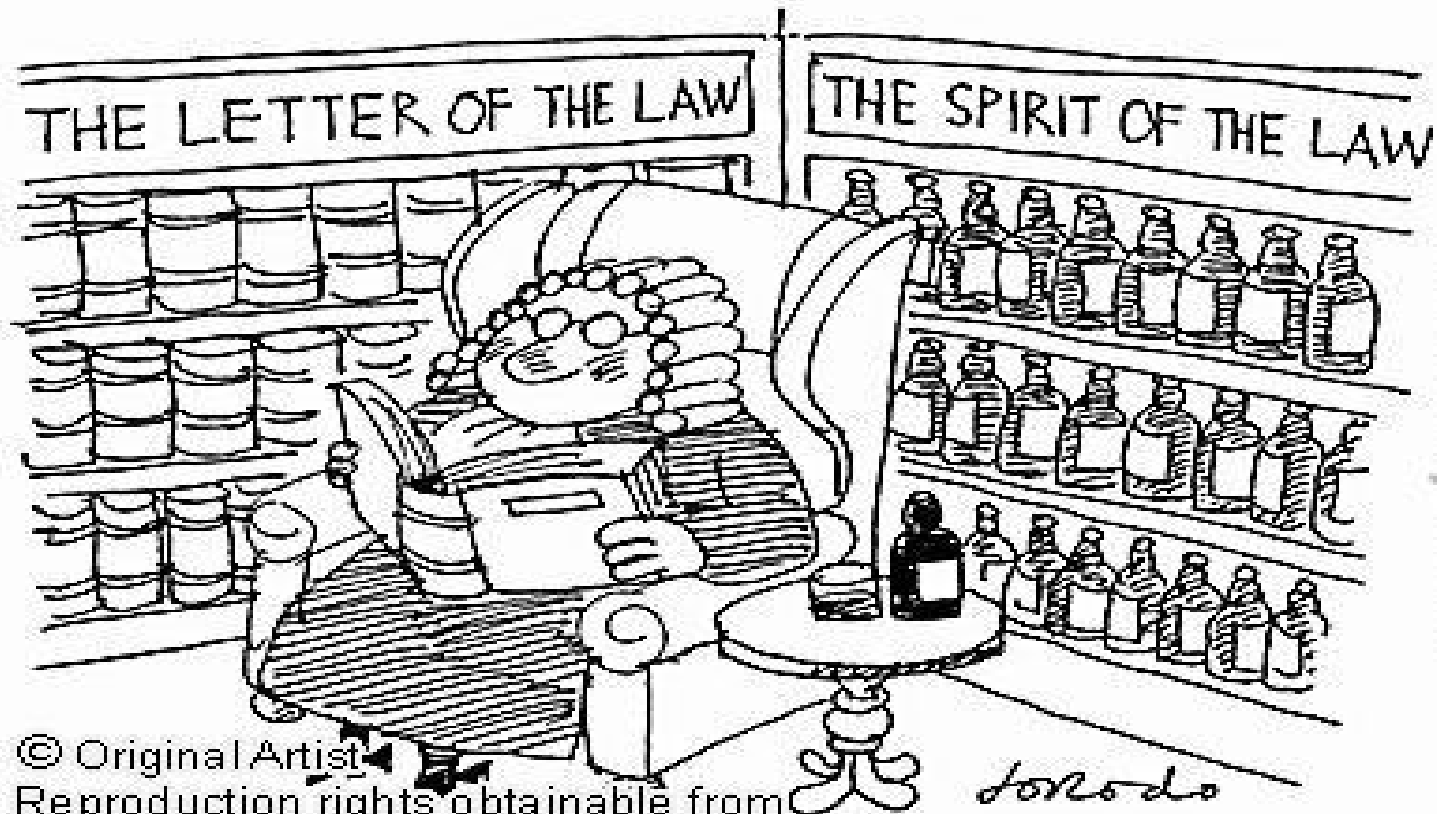

search ID: jd00095

© Original Artist  
Reproduction rights obtainable from  
[www.CartoonStock.com](http://www.CartoonStock.com)

## THE OUTER WALLS = DECISION MAKING



**balanced and consistent actions**

# FIVE FOUNDATIONS

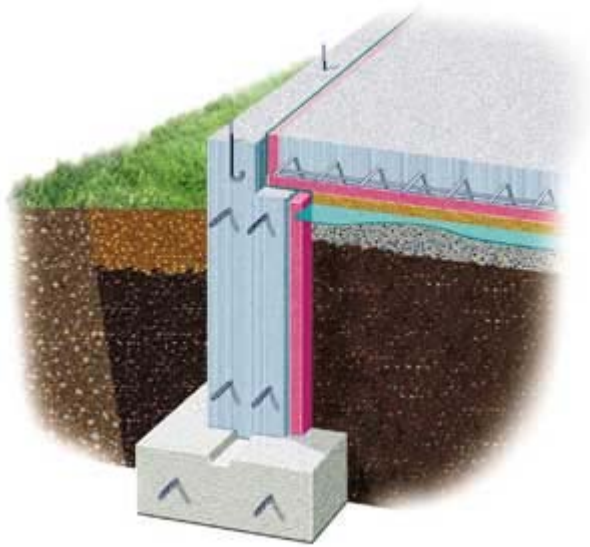

- ✓ **Openness to discussion**
- ✓ **Leading by example**
- ✓ **Feasibility**
- ✓ **Transparency**
- ✓ **Enforcement**





# IDENTIFYING C&I RISKS AND ADVISING ON HOW TO MITIGATE THESE RISKS

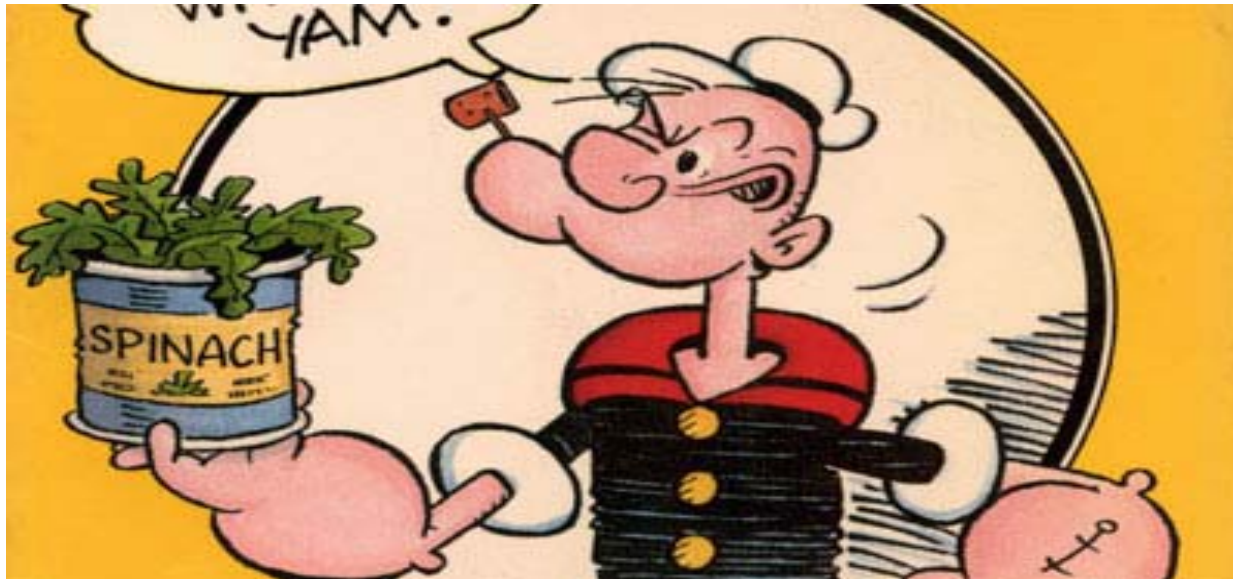

Risk self assessment are less time consuming but also less effective in this stage of the compliance function

# RISK ANALYSES

## Divisions

**DNB  
Horizontal  
Risks**

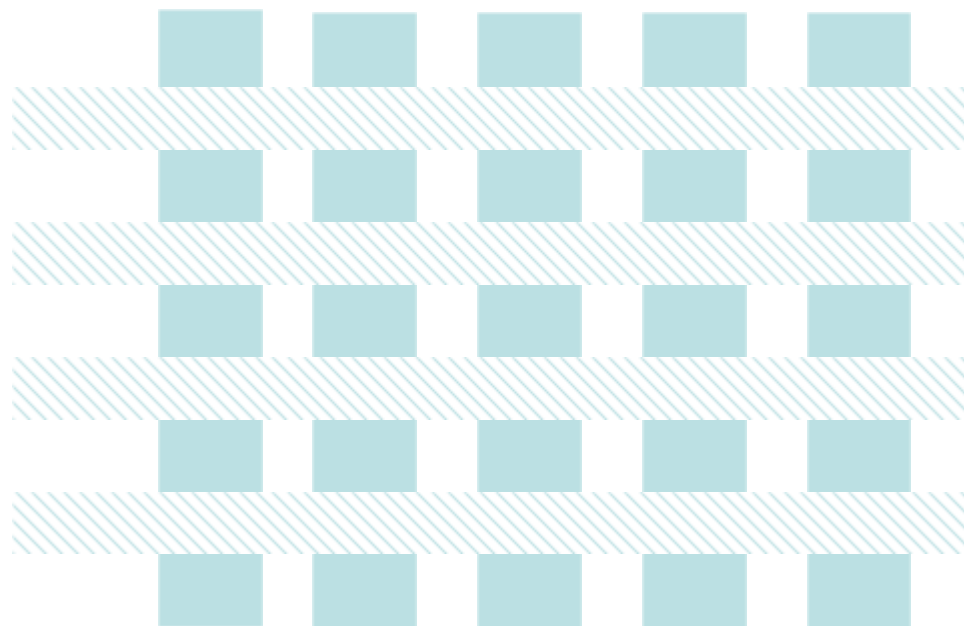

# OPERATING DNB'S RULES OF CONDUCT AND MONITORING COMPLIANCE



**Fast response is essential**

# WHAT IS YOUR EXPERIENCE WITH C&I UP TO NOW?

